

# **Samsung Gear Circle**

## **QUICK REFERENCE MANUAL**

## Table of Contents

Device Functions .....	3
Setting Up Your Gear Circle .....	3
Charging the battery .....	3
Charging indicator .....	3
Turning the Circle on or off .....	4
Connecting to other devices .....	4
Connecting devices using the Gear Manager .....	4
Connecting device via Bluetooth .....	5
Connecting to two devices .....	5
Wearing the Gear Circle .....	6
Joining the magnets .....	6
Attaching the neck guide .....	6
Adjusting the volume .....	6
Using the Gear Circle .....	7
Answering a call .....	7
While wearing the Gear Circle .....	7
Rejecting call .....	7
Switching sound output .....	7
Ending a call .....	7
Playing music .....	7
Pausing and resuming playback .....	7
Launching S Voice .....	7
Controls functions .....	7
Status indicat. ....	8
Reset Gear Circle .....	8
Using the Samsung Gear app .....	9
Notifications .....	9

## Device Functions

---

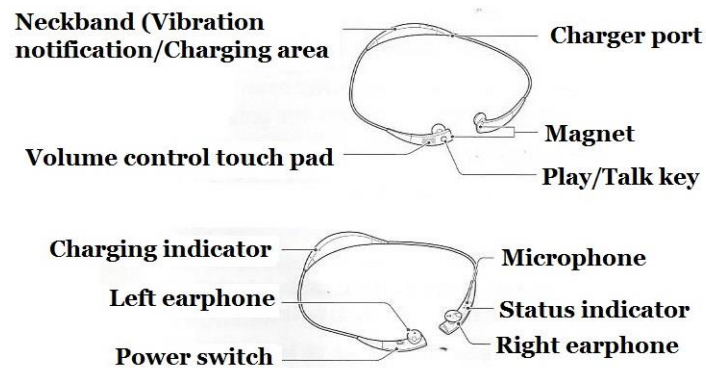

## Setting Up Your Gear Circle

---

### Charging the battery

1. Open the charger port cover and insert the USB cable into the charger port
2. Insert the other end of the USB cable into the charging head, and plug the charging head into an electrical outlet.

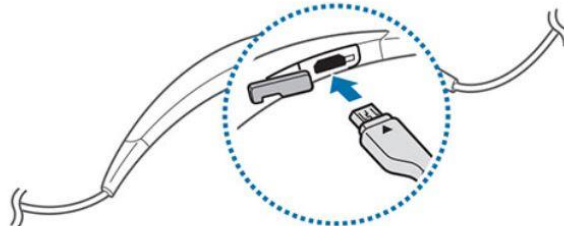

**NOTE:** To save energy, unplug when not in use. Charger doesn't have a power switch, so you must unplug the charger from the electric socket when not in use to avoid wasting power.

### Charging indicator

Charge the battery before using the Gear Circle for the first time. The charging indicator glows **red** during charging and **green** when charging is complete.

- Charging **Red**
- Fully charged **Green**

**Caution:** Use of a non-Samsung charger may damage the Gear Circle and void warranty.

## Turning the Circle on or off

Slide the power switch up or down to turn the circle on or off

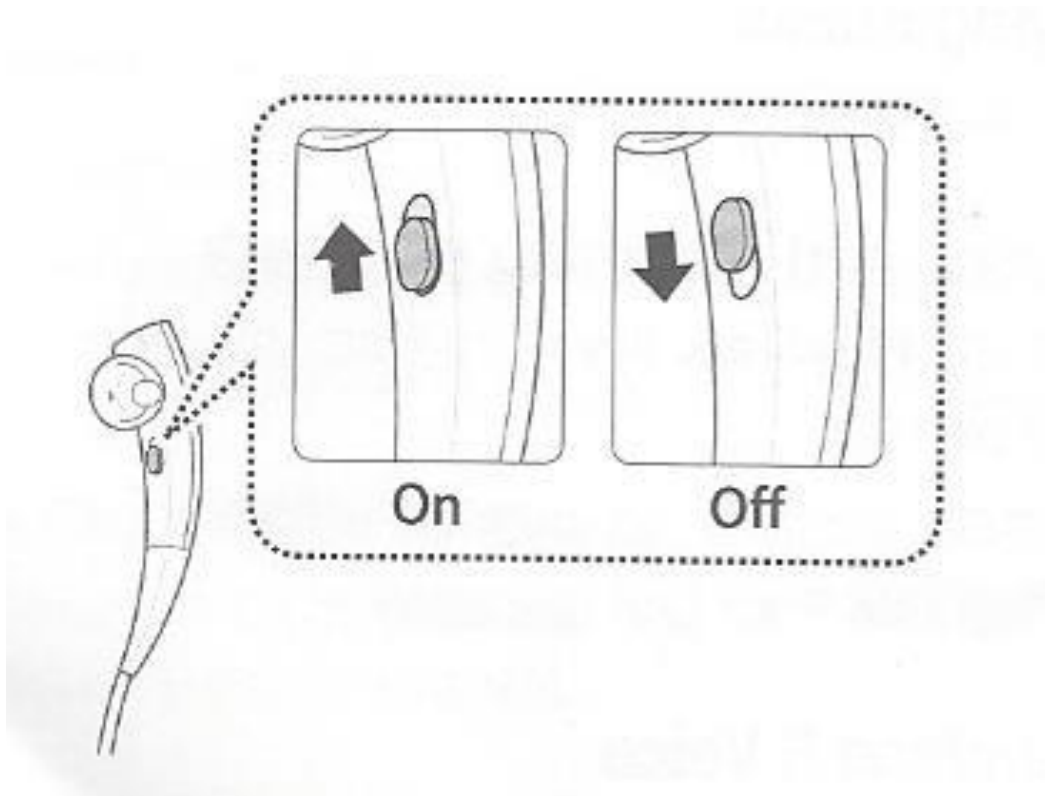

## Connecting to other devices

---

### Connecting devices using the Gear Manager

1. **Other device:** Download the Samsung Gear Manager app from Galaxy Apps.
2. **Other device:** Turn on Bluetooth
3. **Gear Circle:** Turn on the Gear Circle
4. **Other device:** Select the model name.
5. **Other device:** When the Bluetooth pairing request window appears, tap OK
6. **Gear Circle:** When the connection window appears, tap OK.
7. **Other device:** Tap Finish

**Note:** The Samsung Gear app is available for Samsung smartphones that have more than 1 GB of memory and on Android 4.2.2 or higher.

### Connecting device via Bluetooth

When you turn on the Gear Circle for the first time, the Gear Circle automatically enters Bluetooth pairing mode. The status indicator flashes green, blue, and then red for 3 minutes.

1. **Gear Circle:** Turn on the Gear Circle.
2. **Other device:** Turn on the Bluetooth feature and access the Bluetooth menu and scan for the Gear Circle.
3. **Other device:** From the search results, tap Gear Circle.

**NOTE:** if the Circle does not enter Bluetooth pairing mode, separate the earphones and press and hold the **Play/Talk** key for 3 seconds.

### Connecting to two devices

The Gear Circle can connect to two Bluetooth-enabled devices at the same time.

1. After pairing the Gear Circle with Device 1, enter Bluetooth pairing mode again to connect to Device 2.
2. Reconnect Device 1. The Gear Circle is now connected to two devices.

## Wearing the Gear Circle

---

Cover the earphones with the provided earbud tips and put the earphones on. The earphones contain magnets so that they can be joined.

### Joining the magnets

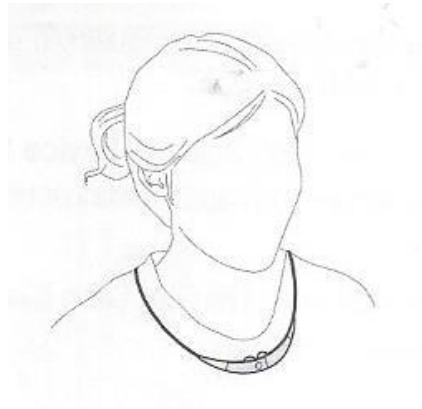

### Attaching the neck guide



**Note:** Wearing the neck guide (during physical activities) will prevent the neckband from falling off.

### Adjusting the volume

Swipe up or down the volume control touch pad to adjust the volume

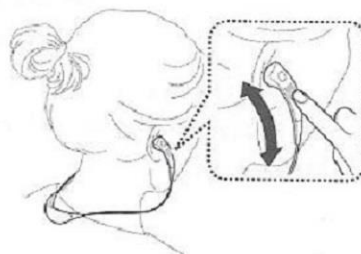

## Using the Gear Circle

---

### Answering a call

#### While wearing the Gear Circle

- Press the **Play/Talk** key.
- Separate the earphones and the call will be received.

### Rejecting call

When a call comes in, press and hold the **Play/Talk** key for 1 second or join the magnets.

### Switching sound output

When the earphones are connected you can automatically switch the sound output to the Gear Circle by separating the earphones.

### Ending a call

Press the **Play/Talk** key or connect the earphones.

### Playing music

Press the **Play/Talk** key.

### Pausing and resuming playback

Press the **Play/Talk** key or connect the earphones and press the **Play/Talk** key.

### Launching S Voice

While you are wearing the Gear Circle, press and hold the **Play/Talk** key for 1 second.

If the connected device support S Voice, you can use the app via the Gear Circle.

### Controls functions

- Power switch: Slide up or down to turn on or off.

- **Play/Talk** key: Press to answer or end a call
  - Press to play music or pause playback
  - Press and hold for 3 seconds to enter Bluetooth pairing mode
  - Press twice to skip to the next song while playing music.
- Volume control touch pad.
  - Swipe upwards or downwards to adjust the volume during media playback or a call.
  - Swipe upwards or downwards to skip the Gear Circle vibration mode for incoming calls.

#### Status indicator

- **Bluetooth pairing mode:** Blinking **green**, blue and red.
- **Power on:** Blinking **blue** 3 times.[
- **Power off:** Blinking **red** 3 times.
- **Incoming call:** Blinking **blue**.

#### Reset Gear Circle

1. Turn off your Gear Circle.
2. Press and hold the **Play/Talk** key on the outside of the right earphone.
3. Turn on the Gear Circle while still holding the **Play/Talk** key.
4. Release the **Play/Talk** key when the Gear Circle vibrates and the indicator light stops blinking

The next time you open the Samsung Gear application on the mobile device your Gear Circle was previously connected to, the device will attempt to reconnect to the Circle. Touch Cancel if you do not want the devices to connect.



## Using the Samsung Gear app

---

If the Circle is connected using the Samsung Gear app, you can access additional features, such as adjusting the sound affect or setting notifications.

- On the connected device, open the Apps screen and tap Samsung gear.

### Gear SoundAlive

Select sound effect or adjust the sound affect manually.

- From the Samsung Gear app, tap Gear SoundAlive.

### Notifications

Set the device to notify you of missed calls and new messages via a voice notification to the Circle.

- From the Samsung Gear app, tap the Notifications > slide the slider to the right to turn it on> manage notifications.

SAMSUNG TELECOMMUNICATIONS AMERICA  
1300 E. Lookout Drive | Richardson, TX 75082  
1.888.987.HELP  
[www.samsung.com/mobile](http://www.samsung.com/mobile)

©2014 Samsung Telecommunications America, L.L.C. Samsung, Gear and are all trademarks of Samsung Electronics Co., Ltd. Bluetooth is a registered trademark of Bluetooth SIG. Other company and product names mentioned herein may be trademarks of their respective owners. Screen images simulated. Appearance of device may vary.